

850nm PM High Power Isolator



Features

Low Insertion Loss
 High Isolation
 High Power Handling
 High Return Loss
 High Extinction Ratio

Applications

Fiber Laser
 Instrumentation
 Fiber Amplifier
 Lab Research

Performance Specifications

| Parameters | Unit | Values |
|---|------|----------------|
| Center Wavelength (λ_c) | nm | 850 |
| Operating Wavelength Range | nm | ± 10 |
| Min. Extinction Ratio (only for B Type) | dB | 20 |
| Min. Extinction Ratio (only for F Type) | dB | 22 |
| Typ. Peak Isolation | dB | 30-35 |
| Min. Isolation at 23°C | dB | 23 |
| Typ. Insertion Loss at 23°C | dB | 0.8 |
| Max. Insertion Loss at 23°C | dB | 1.2 |
| Min. Return Loss (input/output) | dB | 50/50 |
| Max. Optical Power (CW) | mW | 300 or specify |
| Max. Tensile Load | N | 5 |
| Fiber Type | | PM Panda Fiber |
| Operating Temperature | °C | '0 to +60 |
| Storage Temperature | °C | '-20 to+75 |

*Above specifications are for device without connector.

*For devices with connectors, IL will be 0.3dB higher, RL will be 5dB lower and ER will be 2dB lower.

*The PM fiber and connector key are aligned to the slow axis.

Size

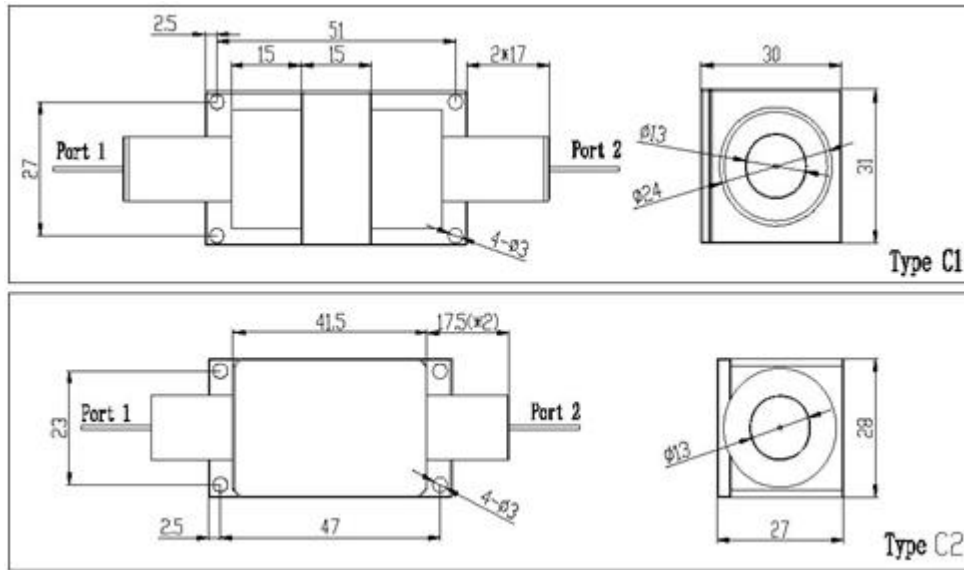

Ordering Information

HPMI-①①-②-③③-④④-⑤

①①: Wavelength

85 - 850nm

SS - Specify

②: Package Type

C1 - Type C1

C2 - Type C2

④: Axis Alignment

F - Fast Axis Blocked

B - Both Axis Working

③③: Connector Type on Port 1 & 2

1 - FC/UPC

2 - FC/APC

3 - SC/UPC

4 - SC/APC

N - None

S - Specify

④④: Fiber Jacket on Port 1 & 2

B - 250um Bare Fiber

L - 900um Loose Tube

C - 3mm Loose Cable

S - Specify

⑤: Fiber Length

1 - 1.0m

S - Specify